

PRINTABLE INFO SHEET

Series: Pennwest Ranch Modular

Model: HR130A Danbury



About This Model

Style: Ranch / Bedrooms: 3 / Bathrooms: 2 / Square Feet: 1647

CUSTOMER CONTACT

Notes: _____

PRINTABLE INFO SHEET

Series: Pennwest Ranch Modular
 Model: HR130A Danbury



Floorplan

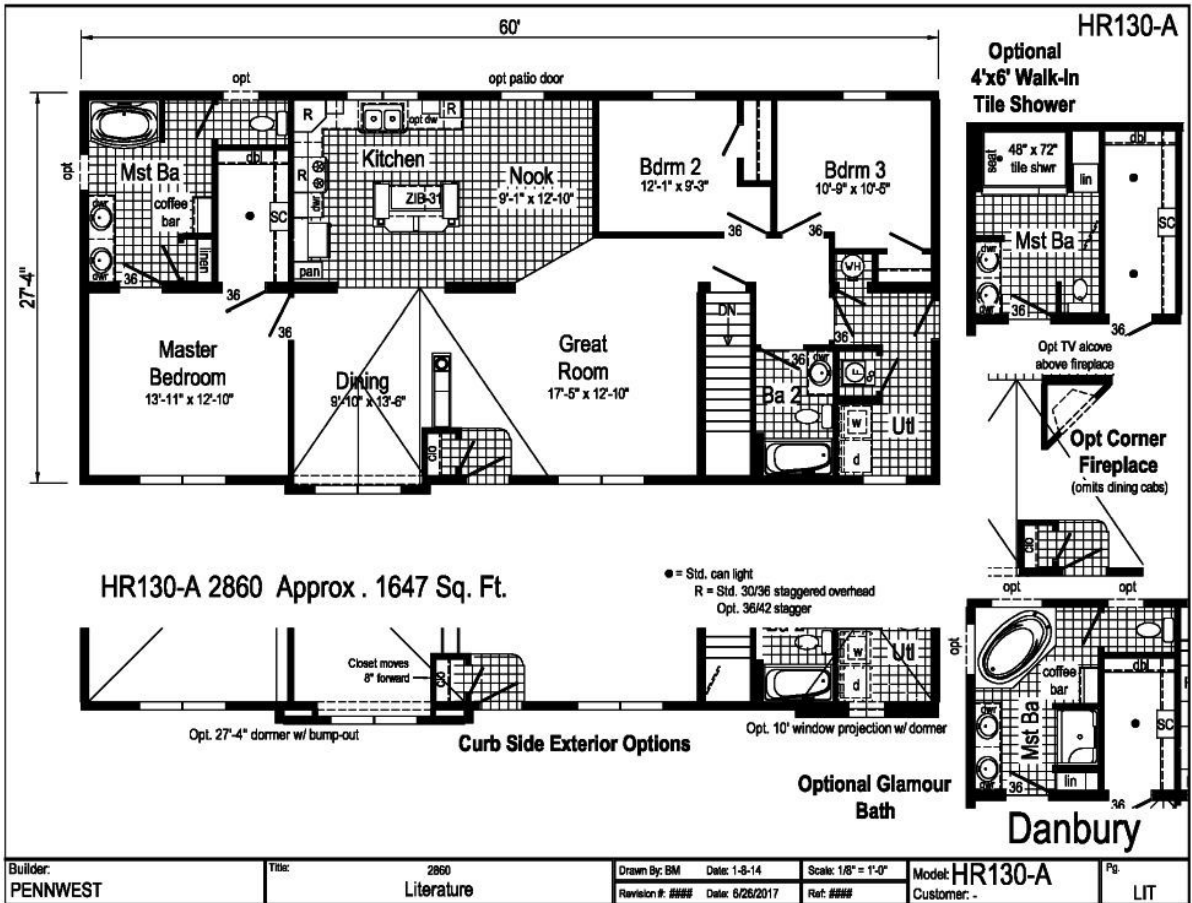

CUSTOMER CONTACT

Notes:

PRINTABLE INFO SHEET

Series: Pennwest Ranch Modular
 Model: HR130A Danbury



Floorplan

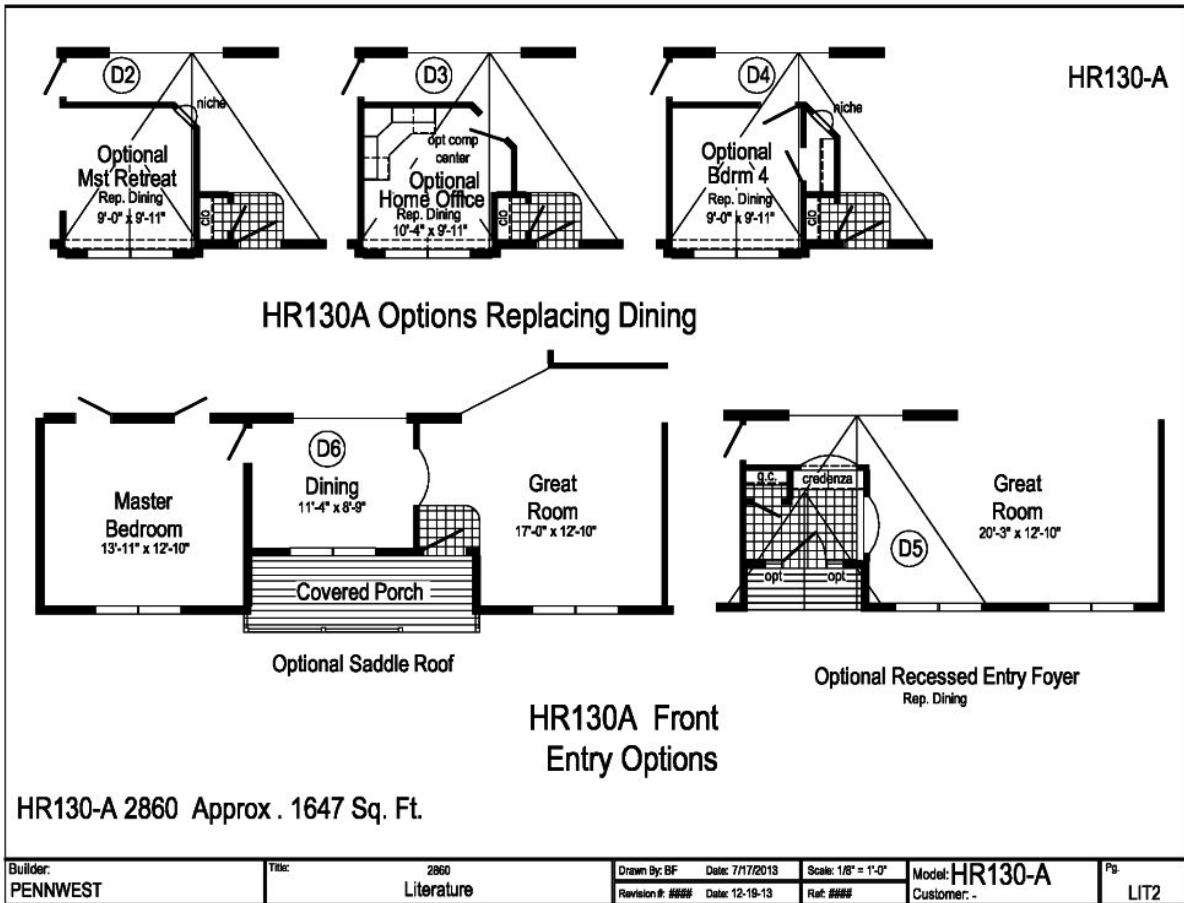

CUSTOMER CONTACT

Notes: _____

PRINTABLE INFO SHEET

Series: Pennwest Ranch Modular
 Model: HR130A Danbury



Floorplan

HR130-A

HR130A Kitchen Options

HR130A Optional Utility

HR130-A 2860 Approx. 1647 Sq. Ft.

Builder: PENNWEST	Title: 2860 Literature	Drawn By: BF Revision #: ###	Date: 7-17-13 Date: 7/17/2014	Scale: 1/8" = 1'-0" Ref: ###	Model: HR130-A Customer: -	Pg: LIT3
----------------------	------------------------------	---------------------------------	----------------------------------	---------------------------------	-------------------------------	-------------

CUSTOMER CONTACT

Notes: _____

PRINTABLE INFO SHEET

Series: Pennwest Ranch Modular
Model: HR130A Danbury



Standards & Features

HOME COMPONENTS

Complete Water Lines Supplied
Complete Electrical
Complete Heating System
Complete Air Return System
Drain and Gas Lines Stubbed Through Floor

INTERIOR

Primed Drywall Throughout
Smooth Flat Ceiling Throughout
8'0" Ceiling Height
Oak Stained or Smooth Painted 6-Panel

Doors with Mortise Hinges
36" Interior Doors - Where Available

Pre-Hung

Lever Interior

Passage Sets
Smoke Detectors with Battery Back-Up
Wire Shelving in Guest Closet
White or Oak Hardwood Stained Moldings Throughout

CABINETRY

Evermore Custom Cabinetry (KCMA Certified)
Choice of Oak or Barnwood Oak 3/4 Overlay Cabinetry
Hardwood 5-Piece

Mission Flat Panel Cabinet Doors
Hardwood Oak Cabinet Face Frames
Upgrade Cabinet Hardware
Hidden Cabinet Hinges
Staggered Overhead Cabinets
Cabinet Crown Moulding on Wall Cabinets

CABINETRY (continued)

Adjustable Shelves in Overhead Cabinets
Drawer-Over-Door Base Cabinets
Dovetail Drawer Construction
100# Undermount Drawer Guides
Vanities with Drawers
36" High Vanities

KITCHEN

5-Arm Brushed Nickel Dining Room Light with Alabaster Glass Shades
Brushed Nickel Pendant Nook Light
Base and Center Shelves in Base Cabinets
Laminate Countertops with Crescent Edge
Full Ceramic Backsplash
Stainless Steel Sink-33x22x8
Huntington Brass Brushed Nickel Single Lever Faucet
Tip-Out Trays at Sink - Most Models
Lazy Susan Base Corner Cabinet - Most Models
30" Deluxe Gas Range
Power Range Hood With Light
18 Cubic Foot, Frost Free Refrigerator
1 USB Receptacle

BATHS

60" One-Piece Fiberglass Tub/Showers
Tub Overflows
Elongated Toilets
China Sinks with Overflows

CUSTOMER CONTACT

Notes:

PRINTABLE INFO SHEET

Series: Pennwest Ranch Modular
Model: HR130A Danbury



Standards & Features (continued)

BATHS (continued)

and Pop-Up Drains
8" Ceramic Backsplash at Tub Deck
Laminate Countertops with Crescent Edge
Lighted Vent Fan in Each Bath
Huntington Brass Brushed Nickel Faucets
Anti-Scald Valves on Showers and Tubs
Linens with Doors ‐
Where Available

FLOORING

Believe It, That's Awesome, Tactile, or Macrame
Carpeting
Rebond Carpet Pad
Tackstrip Carpet Installation
Foyer Entry with Vinyl Flooring
No-Wax Vinyl Floor Coverings
by Congoleum

BEDROOMS

Ceiling Lights
Egress Window Each Bedroom
Wire Shelving with All-Slide Rods in
Wardrobes
Switched 4" Recessed LED Light

Walk-In Closets

UTILITIES

Washer and Dryer Area
200 AMP Electrical Service
Plumb and Wire for Washer
Wire for Dryer
50 Gallon Electric Water Heater

UTILITIES (continued)

with Pan
Energy Efficient 90 Plus Gas Furnaces
Sized to Home
Programmable Thermostat with
8-Wires
Perimeter Heat System
Fiberglass Heat Ducts
Air Return System
Main Water Line Shut-Off Valve
Water Shut-Off Valves Where
Accessible
One Exterior Water Faucet

INSULATION

R-19 Fiberglass Insulation in Walls
R-38 Avg. Batt Insulation in Ceiling

EXTERIOR

Essex Lavastone Lantern Light at
Front Door
Pantina Lantern Light at Rear Door
Two GFI-Protected Exterior Receptacles
Vinyl Ship Lap Siding
O.S.B. Sheathing Under Siding
Wind Wrap Air Infiltration Barrier
5/12 Pitch Roof with 12" Eaves and
Overhangs on Ranch and 2-Story Homes
12/12 Pitch Shingle Roof with 12"
Eaves on Cape Homes
Architectural Shingles
Ridgevent Roof Ventilation System
Ice Shield

in All

CUSTOMER CONTACT

Notes:

PRINTABLE INFO SHEET

Series: Pennwest Ranch Modular

Model: HR130A Danbury



Standards & Features (continued)

EXTERIOR (continued)

3'-0" x 6'-8" Fiberglass Half-Lite Brighton Front Door

w/

Leaded Glass and Deadbolt Lock

3'-0" x 6'-8" Pre-Finished Fiberglass

6-Panel Rear Door w/Deadbolt Lock

Large Vinyl Insulated Argon Filled

Windows with Low-E Glass, Grids

and Wood Sills

15" Raised Panel Shutters on Front

Door Side

CONSTRUCTION

2x10 Transverse Floor System on

16" Centers with 23/32" OSB

Floor Decking**

2x6 Exterior Walls on 16" Centers**

2x4 Interior Walls

90 Mile Exposure C Wind Load Design

40# Roof Load Design

**NOTE: Spacing for Framing Members may vary due to

Design Requirements

CUSTOMER CONTACT

Notes:
