

# PRINTABLE INFO SHEET

Series: Rockbridge Modular Homes  
Model: RB607A Kentwood



## About This Model

Style: Ranch / Bedrooms: 2 / Bathrooms: 2 / Square Feet: 1203

## CUSTOMER CONTACT

Notes:

---

---

---

---

# PRINTABLE INFO SHEET

Series: Rockbridge Modular Homes  
 Model: RB607A Kentwood



## Floorplan

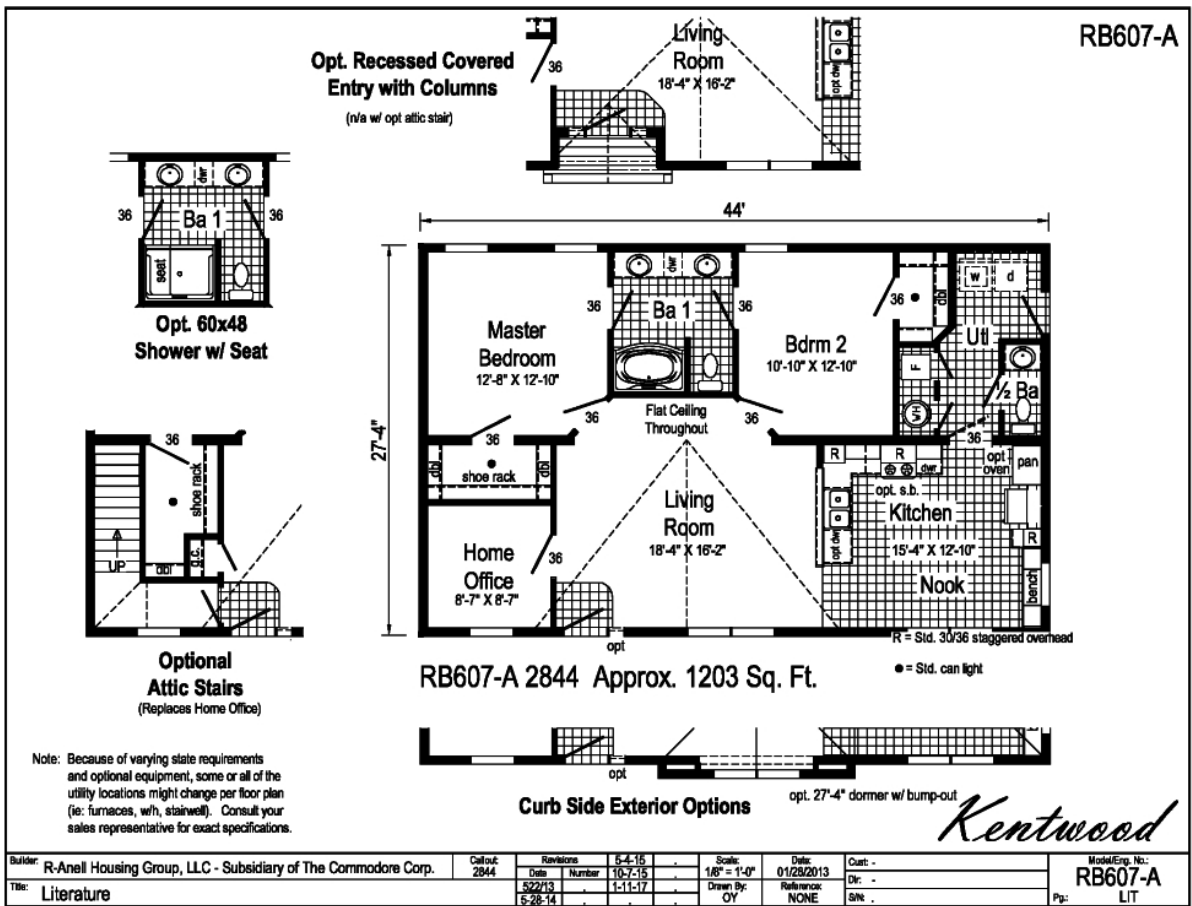

## CUSTOMER CONTACT

Notes: \_\_\_\_\_

\_\_\_\_\_

\_\_\_\_\_

\_\_\_\_\_

# PRINTABLE INFO SHEET



**Series: Rockbridge Modular Homes**  
**Model: RB607A Kentwood**

## Standards & Features

### INTERIOR

Primed Smooth Drywall Throughout  
Flat Ceiling Throughout  
Stipple Ceiling  
8'0" Ceiling Height  
25 oz Carpet with  
ShawGuard Carpet Protector  
8# Carpet Pad  
Tackstrip Carpet Installation  
Entry Foyer with Vinyl Flooring  
No-Wax Vinyl Floor Coverings by Congoleum  
6" Recessed LED Lighting  
3 1/4" Window & Door Trim  
6-Panel Pre-Hung Doors with Mortise Hinges  
White Painted Mouldings Throughout  
Metal Interior Passage Sets  
Smoke Detectors with Battery Back-Up  
Wire Shelving in Guest Closet &  
Utility Room  
2" Window Blinds Throughout  
Nailed on Switch and Recept. Boxes  
Laminate Countertops with Laminate Edging  
4" Laminate Backsplash  
**CABINETS**  
Evermore Custom Cabinetry (KCMA Certified)  
Hardwood Mission Cabinet Doors with  
Full Overlay  
Hardwood Cabinet Face Frames  
Brushed Nickel Cabinet Hardware  
Concealed Cabinet Hinges  
Soft Close Cabinet Doors

### INTERIOR (continued)

Crown Moulding on Wall Cabinets  
30"/36" Staggered Wall Cabinets  
Adjustable Shelves in Wall Cabinets  
Dovetail Drawers w/ Soft Close Guides  
Adjustable Center Shelf in Base Cabinets  
36" High Bath Vanities with Base Shelf  
**KITCHEN**  
Stainless Steel Sink - 33x22x8  
Huntington Brass Nickel Single Lever Faucet  
USB II Receptacle  
Deluxe Free-Standing Electric Range  
Power Range Hood with Light  
18 Cubic Foot, No-Frost Refrigerator  
Island with Stile Framed Panels on Sides & Backs  
**BATHS**  
60" One-Piece Fiberglass Tub/Showers  
with Ceramic Tile Edge  
One-Piece Fiberglass Shower with  
Ceramic Tile Edge and a Glass  
Door in Glamour Baths  
Fiberglass Soaker Tub In Glamour Baths  
Tub Overflows  
End Drain on Tubs/Showers  
1.6 Gallon Per Flush Elongated Toilets  
China Stool, Tank & Lid  
China Sinks with Overflows and Pop-Up  
Drains  
Lighted Vent Fan in Each Bath  
Huntington Brass Brushed Nickel Faucets  
Anti-Scald Valves on Showers & Tubs

## CUSTOMER CONTACT

Notes: \_\_\_\_\_  
\_\_\_\_\_  
\_\_\_\_\_  
\_\_\_\_\_

# PRINTABLE INFO SHEET



**Series: Rockbridge Modular Homes**  
**Model: RB607A Kentwood**

## Standards & Features (continued)

### INTERIOR (continued)

- 2-Light Vanity Fixture
- Privacy Lock Sets in all Bathrooms
- BEDROOMS**
- Ceiling Lights
- Egress Window Each Bedroom
- Double Wire Shelves with Shoe Racks in Walk-In Closets
- Wire Shelving in Secondary Closets
- 30" Interior Passage Doors
- Recessed 4" LED Light in Walk-In Closets
- Privacy Lock Sets in all Bedrooms

### UTILITIES

- 200 AMP Electrical Service
- Arc Fault Circuit Breakers
- Plumb and Wire for Washer
- Wire and Vent for Dryer
- 40 Gallon Electric Water Heater with Pan
- Air Ready Electric Furnace w/Coil Cabinet
- 6-Panel Furnace Door
- Perimeter Heat, Fiberglass Ducts, & Return Air System
- Copper Wiring Throughout
- Main Water Line Shut-Off Valve
- Water Shut-Off Valves - Where Accessible
- One Exterior Water Faucet
- Recessed Dryer Vent Box - Where Available
- Uponer Plumbing Connections
- Drain Lines Stubbed Through Floor
- Insulated Hot Water Lines and P-Traps
- Complete Heat System

### UTILITIES (continued)

- Ceiling Jumper Box HVAC Return Air System

### INSULATION

- R-30 Fiberglass Insulation in Floor
- R-19 Fiberglass Insulation in Walls
- R-38 Avg. Blown Insulation in Ceiling

### EXTERIOR

- Patina Lantern Light at Front & Rear Door
- Two GFI-Protected Exterior Receptacles
- Vinyl Dutch Lap Siding
- O.S.B. Sheathing Under Siding
- 5/12 Roof Pitch
- 10" or 12" Overhangs & Eaves (Depending on Model)
- Architectural Shingles, 30 Year Ridgevent Roof Ventilation System
- 36" Fiberglass 6-Panel Front Door with Dead Bolt
- 36" 9-Lite Fiberglass Rear Door with Dead Bolt
- Vinyl Insulated Windows with Low-E Glass
- 15" Raised Panel Shutters on Front Door Side
- Wind Wrap
- Vapor Barrier

### CONSTRUCTION

- 2x10 Floor System on 16" Centers with 3/4" T&G O.S.B.

## CUSTOMER CONTACT

Notes:

---

---

---

---

## PRINTABLE INFO SHEET

Series: Rockbridge Modular Homes

Model: RB607A Kentwood



## Standards & Features (continued)

### CONSTRUCTION (continued)

Floor Decking\*\*

Toilet Riser in Wall

2x6 Exterior Walls on 16" Centers\*\*

2x4 Interior Walls

2x4 Marriage Walls

82-1/2" Window Headers

20# Roof Load Design

90 Mile Exposure B Wind Load Design

(VA-TN)

115 Mile Exposure B Wind Load Design

(NC-SC-WV)

\*\*Spacing for Framing Members may vary due to Design Requirements

## CUSTOMER CONTACT

Notes:

---

---

---

---